



# ASADOR ALFONSO

ALFONSO, CAVITE PHILIPPINES

Asador Alfonso is 4-villa residence and private dining space nestled amidst a 9.4-hectare farm and leisure development. Inspired by the majestic presence of most iconic and active volcanoes of the Philippines- the Taal Volcano. Like a dormant giant awakening, this structure rises from the earth, its design rooted in the local context it inhabits fostering a unique narrative of place making. Promoting ethos of health and well-being through nature, it offers a retreat from city life.

As you approach, the architecture appears to integrate with the terrain, its cavernous spaces inviting exploration and contemplation. In the second floor, you are offered with an expansive horizontal view of the farmland. On the lofted third floor, a cantilevered lounge juts out with a triangulated framing of the sky, the pavilion and the chicken coop. As you ascend to the fourth floor, intimacy embraces you, with private spaces framing both farmland and sunsets. The view evolves with each level, culminating in different perspective of the ever-changing sky. At sunset, the building transforms, harmoniously merging with nature, especially by the sunken bonfire, creating a magical experience that captivates the soul. Nearby, a shimmering pool reflects the illuminated facade of the building, casting a captivating glow that mesmerizes the senses like a lantern at night.

Striking architectural elements, like the gravity-defying illusion of the folding concrete deep cantilevers, serving not only as a design statement but also as effective sun shades, enhancing comfort. Private villas encircle the landscape, framing serene nature views comparable to still-life paintings scenarios. In the private dining spaces, gastronomic journey is elevated by the fusion of bold architecture and fertile farmland.

Inspired by the raw beauty of lava rock formations, this unique structure embodies the harmonious fusion of nature and manmade. Asador Alfonso stands as a stimulus of the locale, poised to leave an indelible mark on its surroundings and ignite a new era of growth and vitality. This is more than just a building; it is a living, breathing symbol of the enduring bond between humanity and the land. In its embrace, visitors find a sense of well-being, inspiration, and a renewed appreciation for agricultural life.

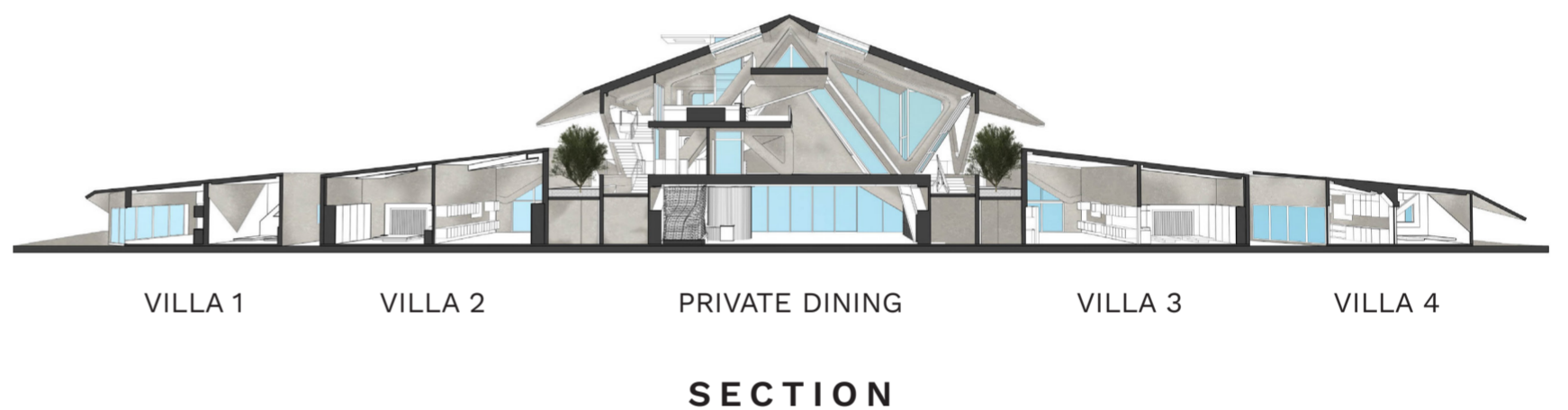



The Asador Alfonso pioneers the integration of recycled plastic pellets sourced from post-consumer plastic waste (from plastic bottles and plastic sachets), meticulously processed from white HDPE bottles into high-quality pellets aggregates. Utilizing 160 sacks or 4-tons of these pellets, equivalent to 150,000-600,000 pieces of plastic bottles. The project showcases sustainability, recycling and material innovation offering diverse textures like confetti, speckled, and fossilized imprints that mimic terrazzo textures giving a sense of surprise that these were plastic waste.

